



Article number:

4005006401TGE

Braked castor 50 mm, wheel brake, TPU-tyre

Swivel bracket with wheel brake. Made of zinc-chromatized pressed sheet metal with double ball race swivel. Center hole fitting. Riveted wheel axle. Inline wheel with transparent TPU-tyre. Hub made of grey polycarbonate. Plain bearing.



Image may differ from the actual product.*

DIMENSIONS

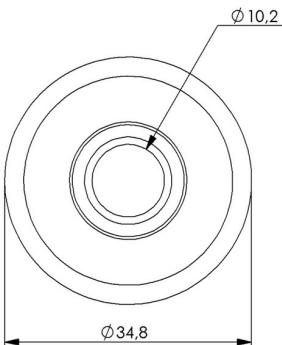

SPECIFICATIONS

Diameter	50 mm
Totalt height	64 mm
Load Capacity (dynamic)	40 kg
Castor model	Brake
Fitting	Centre hole
Material Tread	Polyurethane
Bearing	Rivet
Thread hardness (Shore°)	98° Shore A
Centre Bolt Hole	10.2 mm
Brake	Wheel brake
Width of tread	20 mm
Material Hub	Polycarbonate (PC)
Wheel Pattern	EN 12530
Color Tread	Transparent
Material Type	RoHS (EU) - Approved
Teststandard	EN 12530
Offset	17,5 mm
Material Thickness Bracket	1,5 mm
Swivel radius	65 mm
Temperature Range	-20°C to +50°C

Numeric values in the technical specification can be nominal/rounded to the cneares standard dimension. To see exact values, please use the drawing.