

PRODUCT DATA SHEET

2024-04-09



Article number:

4107000211S

Swivel castor 75 mm, PP-wheel

Swivel bracket. Made of zinc-chromatized pressed sheet metal with double ball race swivel. Center hole fitting. Riveted wheel axle. Wheel made of black PP. Plain bearing.



Image may differ from the actual product.*

DIMENSIONS

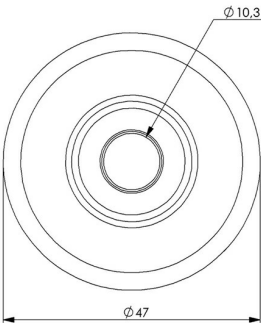

SPECIFICATIONS

Diameter	75 mm
Totalt height	98 mm
Load Capacity (dynamic)	55 kg
Castor model	Swivel
Fitting	Centre hole
Material Tread	Polypropylene (PP)
Bearing	Plain bearing
Thread hardness (Shore°)	75° Shore D
Centre Bolt Hole	10.2 mm
Width of tread	20 mm
Material Hub	Polypropylen (pp)
Wheel Pattern	EN 12530
Color Tread	Black
Material Type	RoHS (EU) - Approved
Teststandard	EN 12530
Offset	35 mm
Material Thickness Bracket	2 mm
Swivel radius	72,5 mm
Product Weight	0,23 kg
Temperature Range	-20°C to +50°C

Numeric values in the technical specification can be nominal/rounded to the cneares standard dimension. To see exact values, please use the drawing.