

PRODUCT DATA SHEET

2024-04-17



Article number:

4105650601ESD1

Swivel castor twin wheel 50 mm, TPE-tyre, conductiv

Swivel bracket for twin wheel. Made of zinc-chromatized pressed sheet metal with double ball race swivel. Center hole fitting. Riveted wheel axle. Wheel with grey TPE-tyre. Hub made of grey PP. Plain bearing. ESD.



Image may differ from the actual product.*

DIMENSIONS

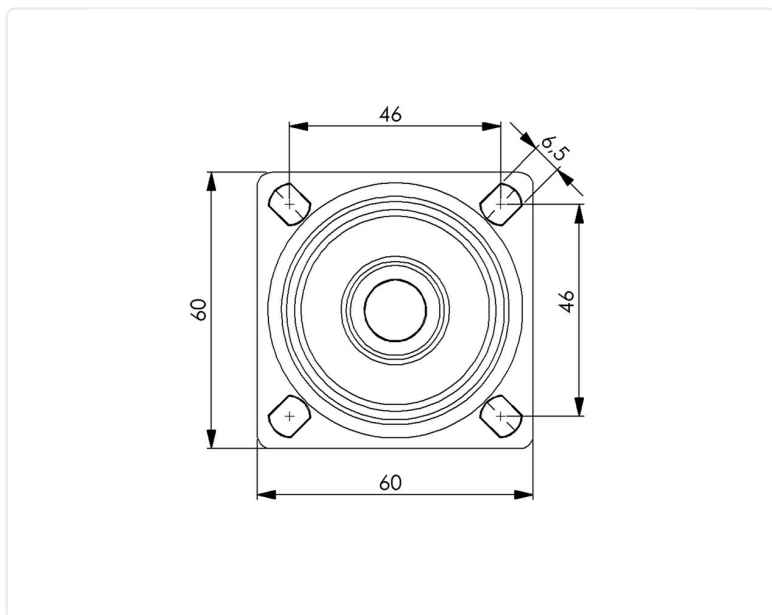

SPECIFICATIONS

Diameter	50 mm
Total height	70 mm
Load Capacity (dynamic)	70 kg
Castor model	Swivel
Fitting	Top plate
Material Tread	TPE
Bearing	Rivet
Plate Size	60x60 mm
CC Distance	46x46 mm
Thread hardness (Shore°)	98° Shore A
Width of tread	20 mm
Material Hub	Polypropylen (pp)
Top Hole	8,5x6,5 mm
ESD	Yes
Wheel Pattern	EN 12530
Color Tread	Grey
Material Type	RoHS (EU) - Approved
Teststandard	EN 12530
Offset	24.5 mm
Material Thickness Bracket	2 mm
Material thickness plate	2 mm
Swivel radius	49.5 mm
Product Weight	0.23 kg
Temperature Range	-20°C to +50°C
ESD	Conductive ($\leq 1 \text{ M}\Omega$)

Numeric values in the technical specification can be nominal/rounded to the nearest standard dimension. To see exact values, please use the drawing.