

# PRODUCT DATA SHEET

2024-04-04



Article number:

4005006601ESD1

Braked castor 50 mm, wheel brake, TPE-tyre, conductiv

Swivel bracket with wheel brake. Made of zinc-chromatized pressed sheet metal with double ball race swivel. Center hole fitting. Riveted wheel axle. Wheel with grey TPE-tyre. Hub made of grey PP. Plain bearing. ESD.



Image may differ from the actual product.\*

## DIMENSIONS

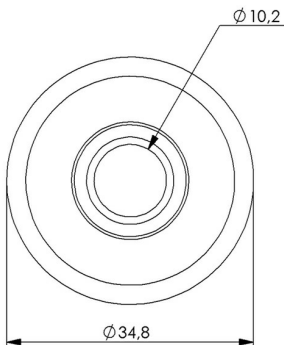

## SPECIFICATIONS

Diameter	50 mm
Totalt height	64 mm
Load Capacity (dynamic)	40 kg
Castor model	Brake
Fitting	Centre hole
Material Tread	TPE
Bearing	Rivet
Thread hardness (Shore°)	85° Shore A
Centre Bolt Hole	10.2 mm
Brake	Wheel brake
Width of tread	20 mm
Material Hub	Polypropylen (pp)
ESD	Yes
Wheel Pattern	EN 12530
Color Tread	Grey
Material Type	RoHS (EU) - Approved
Teststandard	EN 12530
Offset	17.5 mm
Material Thickness Bracket	1.5 mm
Swivel radius	65 mm
Product Weight	0.11 kg
Temperature Range	-20°C to +50°C
ESD	Conductive ( $\leq 1\text{ M}\Omega$ )

Numeric values in the technical specification can be nominal/rounded to the nearest standard dimension. To see exact values, please use the drawing.