

PRODUCT DATA SHEET

2024-04-10



Article number:

5E2068A432BV-HD

Automatic Return swivel castor 200 mm, TPU-tyre

Swivel bracket with automatic return. Made of zinc-chromatized pressed sheet metal with double ball race swivel. Top plate fitting. Wheel axle with nut. Wheel with red TPU-tyre. Hub made of Nylon/PA6. Double Ball bearing.



Image may differ from the actual product.*

DIMENSIONS

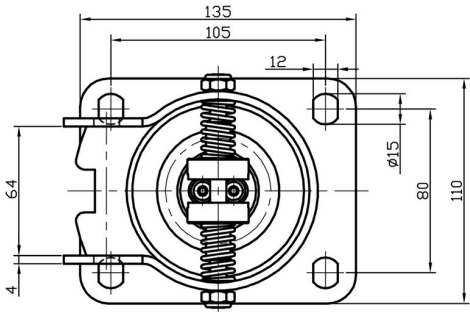

SPECIFICATIONS

Diameter	200 mm
Totalt height	239 mm
Load Capacity (dynamic)	500 kg
Castor model	Automatic Return
Fitting	Top plate
Material Tread	Polyurethane
Bearing	Double Ball bearing
Plate Size	140x110 mm
CC Distance	105x80 mm
Thread hardness (Shore°)	98° Shore A
Width of tread	45 mm
Material Hub	Nylon PA6
Top Hole	13 mm
Dyn. Load Capacity (4km/)	500 kg
Color Tread	Red
Material Type	RoHS (EU) - Approved
Offset	65 mm
Material Thickness Bracket	4 mm
Materialthicknessplate	6 mm
Product Weight	3,3 kg
Temperature Range	-20°C to +70°C

Numeric values in the technical specification can be nominal/rounded to the nearest standard dimension. To see exact values, please use the drawing.