

# PRODUCT DATA SHEET

2024-04-10



Article number:

5812665433GS 

Braked castor 125 mm, total stop brake, TPU-tyre

Swivel bracket with total stop brake. Made of zinc-chromatized pressed sheet metal with double ball race swivel. Top plate fitting. Wheel axle with nut. Wheel with grey TPU-tyre. Hub made of black Nylon/PA6G with threadguards. Ball bearing.



Image may differ from the actual product.\*

## DIMENSIONS

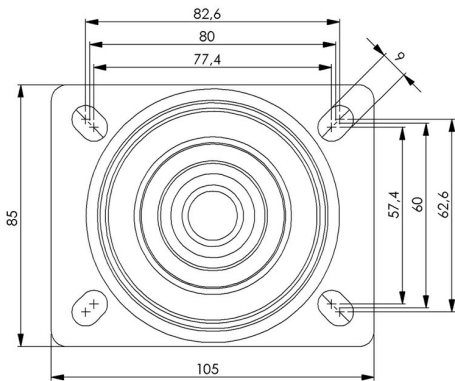

## SPECIFICATIONS

Diameter	125 mm
Totalt height	157 mm
Load Capacity (dynamic)	225 kg
Castor model	Brake
Fitting	Top plate
Material Tread	Polyurethane
Bearing	Ball bearing
Plate Size	105x85 mm
CC Distance	80x60 mm
Thread hardness (Shore°)	98° Shore A
Brake	Total brake
Width of tread	36 mm
Material Hub	Nylon PA6
Top Hole	12,5x9 mm
Color Tread	Grey
Material Type	RoHS (EU) - Approved
Teststandard	EN 12532
Offset	42 mm
Material Thickness Bracket	2,5 mm
Materialthickplate	3 mm
Swivel radius	129 mm
Product Weight	1,14 kg
Temperature Range	-30°C to +70°C

Numeric values in the technical specification can be nominal/rounded to the nearest standard dimension. To see exact values, please use the drawing.