

# PRODUCT DATA SHEET

2024-04-10



Article number:

5810665333GG

Braked castor 100 mm, total stop brake, TPE-tyre

Swivel bracket with total stop brake. Made of zinc-chromatized pressed sheet metal with double ball race swivel. Top plate fitting. Wheel axle with nut. Wheel with grey TPE-tyre. Hub made of grey PP with threadguards. Ball bearing.



Image may differ from the actual product.\*

## DIMENSIONS

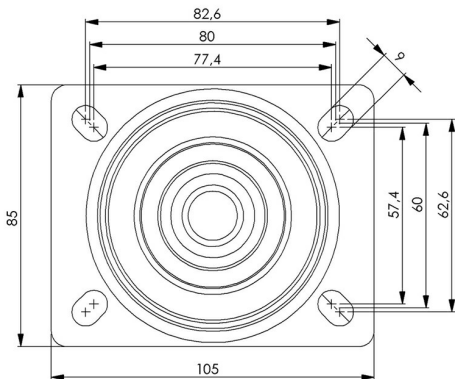

## SPECIFICATIONS

Diameter	100 mm
Totalt height	132 mm
Load Capacity (dynamic)	100 kg
Castor model	Brake
Fitting	Top plate
Material Tread	TPE
Bearing	Ball bearing
Plate Size	105x85 mm
CC Distance	80x60 mm
Thread hardness (Shore°)	85° Shore A
Brake	Total brake
Width of tread	32 mm
Material Hub	Polypropylen (pp)
Top Hole	12,5x9 mm
Static Load Capacity	200 kg
Color Tread	Grey
Material Type	RoHS (EU) - Approved
Teststandard	EN 12530
Offset	41 mm
Material Thickness Bracket	2.5 mm
Materialthickplate	3 mm
Swivel radius	129 mm
Product Weight	1 kg

Numeric values in the technical specification can be nominal/rounded to the nearest standard dimension. To see exact values, please use the drawing.