

PRODUCT DATA SHEET

2024-04-09



Article number:

5A16680932GGX

Swivel castor 160 mm, elastic rubber-tyre, stainless

Swivel bracket. Pressed stainless steel with double ball race swivel. Top plate fitting. Wheel axle with nut. Wheel with grey elastic rubber-tyre. Hub made of grey Nylon/PA6. Plain bearing.



Image may differ from the actual product.*

DIMENSIONS

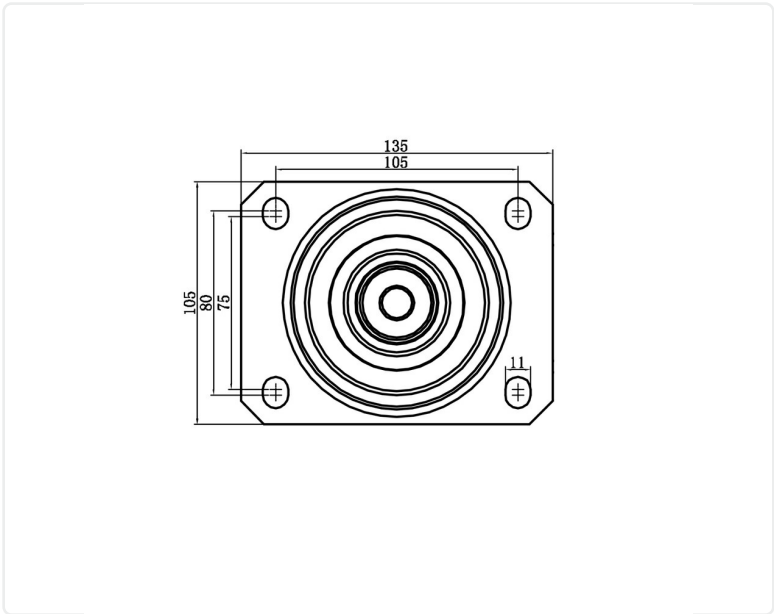

SPECIFICATIONS

Diameter	160 mm
Totalt height	200 mm
Load Capacity (dynamic)	350 kg
Castor model	Swivel
Fitting	Top plate
Material Tread	Elastic Rubber
Bearing	Double Ball bearing
Plate Size	140x110 mm
CC Distance	105x80 mm
Thread hardness (Shore°)	75° Shore A
Width of tread	45 mm
Material Hub	Nylon PA6
Top Hole	11 mm
Stainless	Yes
Dyn. Load Capacity (4km/)	350 kg
Color Tread	Grey
Material Type	RoHS (EU) - Approved
Offset	55 mm
Material Thickness Bracket	2,5 mm
Materialthickplate	2,5 mm
Product Weight	2,02 kg
Temperature Range	-20°C to +60°C

Numeric values in the technical specification can be nominal/rounded to the chreares standard dimension. To see exact values, please use the drawing.