

PRODUCT DATA SHEET

2024-04-09



Article number:

52126604320Z-ALU

Swivel castor 125 mm, PU-tyre

Swivel bracket. Made of zinc-chromatized pressed sheet metal with double ball race swivel. Top plate fitting. Wheel axle with nut. Wheel with orange PU-tyre. Hub made of aluminium. Double Ball bearing.



Image may differ from the actual product.*

DIMENSIONS

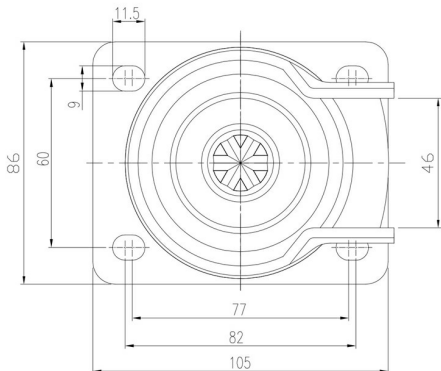

SPECIFICATIONS

Diameter	125 mm
Totalt height	156 mm
Load Capacity (dynamic)	350 kg
Castor model	Swivel
Fitting	Top plate
Material Tread	Polyurethane
Bearing	Double Ball bearing
Plate Size	105x85 mm
CC Distance	80x60 mm
Thread hardness (Shore°)	93° Shore A
Width of tread	38 mm
Material Hub	Aluminium
Top Hole	9 mm
Dyn. Load Capacity (4km/)	350 kg
Color Tread	Orange
Material Type	RoHS (EU) - Approved
Offset	42,5 mm
Material Thickness Bracket	3,5 mm
Materialthicknessplate	4 mm
Product Weight	1,24 kg
Temperature Range	-20°C to +70°C

Numeric values in the technical specification can be nominal/rounded to the nearest standard dimension. To see exact values, please use the drawing.