

PRODUCT DATA SHEET

2024-04-10



Article number:

5E2068A232N-HD

Automatic Return swivel castor 200 mm, PA6-wheel

Swivel bracket with automatic return. Made of zinc-chromatized pressed sheet metal with double ball race swivel. Top plate fitting. Wheel axle with nut. Wheel made of white Nylon/PA6. Double Ball bearing.



Image may differ from the actual product.*

DIMENSIONS

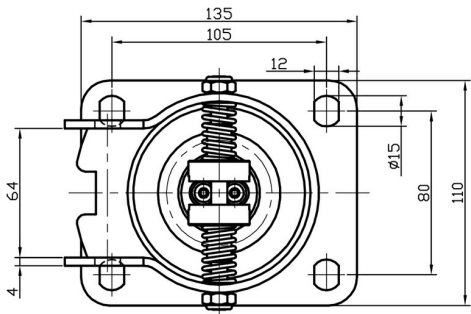

SPECIFICATIONS

Diameter	200 mm
Totalt height	239 mm
Load Capacity (dynamic)	600 kg
Castor model	Automatic Return
Fitting	Top plate
Material Tread	Nylon PA6
Bearing	Double Ball bearing
Plate Size	140x110 mm
CC Distance	105x80 mm
Thread hardness (Shore°)	83° Shore D
Width of tread	50 mm
Material Hub	Nylon PA6
Top Hole	13 mm
Dyn. Load Capacity (4km/)	600 kg
Color Tread	Nature
Material Type	RoHS (EU) - Approved
Offset	65 mm
Material Thickness Bracket	4 mm
Materialthicknessplate	6 mm
Product Weight	3,35 kg
Temperature Range	-20°C to +70°C

Numeric values in the technical specification can be nominal/rounded to the nearest standard dimension. To see exact values, please use the drawing.